

# IMX Servo Linear Actuator

Simple.

Compact.

Powerful.



The IMX Servo Linear Actuator delivers up to 26 kN (5,850 lbf) of force in a patented compact design with a built in high torque motor driving precision screw technology,

The IMX streamlines the process of selection, design and commissioning of linear solutions.

Supported by digital tools to select the right actuator and ensure compatibility with the industry's leading servo drive manufacturers, you'll have all of the data you need for design, installation and commissioning in just a few clicks.

		IMX90	
		ST	HT
MAX. PEAK FORCE	kN	20.0	26.0
	lbf	4,500	5,850
MAX. CONTINUOUS FORCE	kN	15.7	20.0
	lbf	3,540	4,500
MAX. VELOCITY	mm/sec	1,330	
	in/sec	52.0	
STROKE	mm	600	
	in	24	
TEMPERATURE RANGE**	°C	-20 to 60	
	°F	-4 to 140	
ACCURACY	mm/300mm	+/- 0.0102	
	in/ft	± 0.0004	
BALL NUT	mm/300mm	+/- 0.051	
	in/ft	± 0.002	

\*\*Contact Tolomatic if operation outside of standard temperature range is required

**Tolomatic**<sup>TM</sup>

# IMX Servo Linear Actuator

## Dimensions

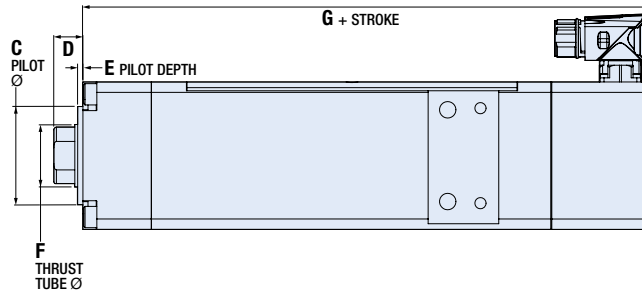
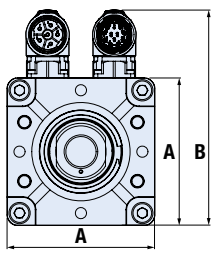

IMX90		
	mm	in
A	90.0	3.54
B	131.4	5.17
C	60.0	2.36
D	17.8	0.70
E	3.2	0.13
F	38.1	1.50
G	187.0	7.36

## Features

- 230V or 460V operation
- IP67 Ingress protection
- Replaceable thrust rod wiper/seal
- Simple re-lubrication
- Water cooled option for increased performance
- Internal anti-rotate option
- Brake with 24V electronic release
- Compatible with leading servo drive manufacturers



## Sizing Tool

- Create complex motion profiles
- Compare and optimize in real time
- Save projects for future reference



## Drive Integration Tool

- Check compatibility with drive manufacturers and encoders
- Access all parameters needed to commission the system
- Review cable recommendations and pin outs

## Mounting Options

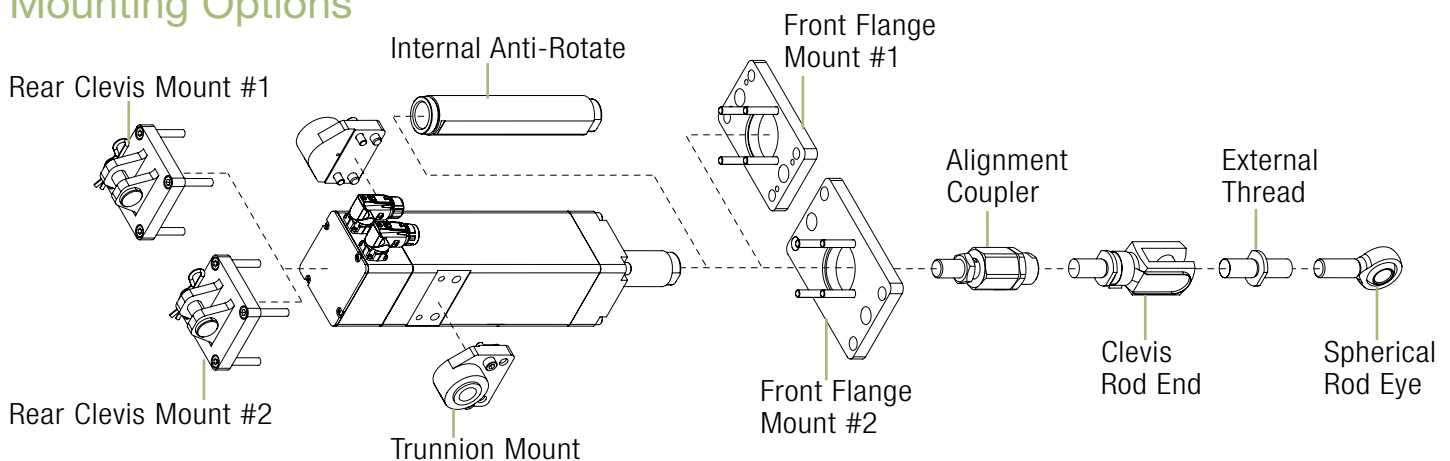

**Tolomatic**<sup>TM</sup>

All data subject to modification  
Date: 202503271345